

## GEZE TS 4000

### Surface-mounted rack and pinion door closer, closing force size 1-6 and size 5-7 according to EN 1154

#### Product features

- ▶ Closing force size EN 1-6 and size EN 5-7 adjustable
- ▶ Closer in only one construction size
- ▶ Optical power size indicator
- ▶ Backcheck and thermo constant closing speed adjustable at front
- ▶ Latching action adjusted via link arm
- ▶ Safety valve in open and close direction

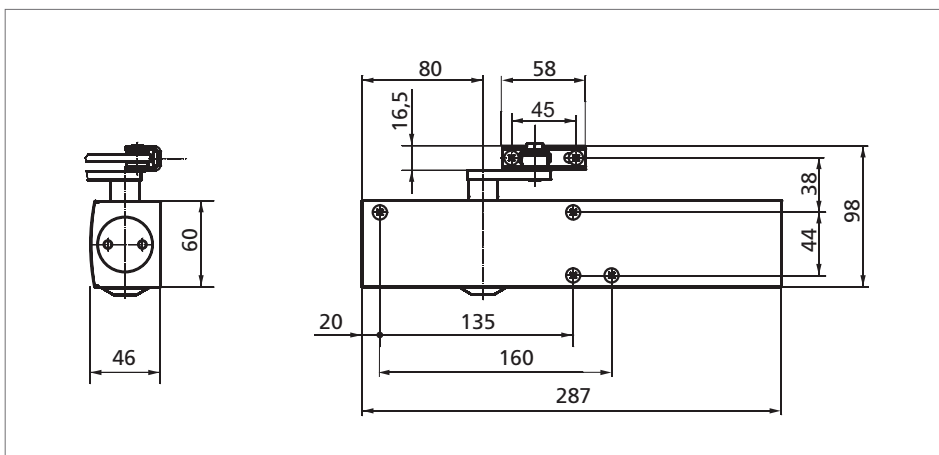

Fig. 16-1

#### Application range

- ▶ For single-action doors, door leaf widths up to 1400 mm (size 1-6) resp. 1600 mm (size 5-7)
- ▶ Can be used for right and left hand doors without adjustment
- ▶ For smoke and fire-proof doors
- ▶ Standard type of installation: door mount, transom mounting is possible

Standard version/package

Overhead door closer GEZE TS 4000 complete with screw accessories and installation template (mounting plate not included); still needed: link arm

- ▶ **GEZETS 4000 with hold-open link arm**  
for an adjustable opening angle up to 150°  
(not permitted for use on smoke and fire-proof doors)
- ▶ **GEZETS 4000 S**  
with delayed closing up to 30 sec., adjustable at front  
(delayed closing is not effective for transom mounting on opposite hinge side)

Specification text

Overhead door closer GEZE TS 4000 for mounting on smoke and fire-proof doors, size 1-6 and 5-7 as per EN 1154 A, closing force adjustable at front with size 1-6, closing speed and backcheck adjustable at front, with visual size indicator, standard type of installation: door mount / hinge side, also available with optional mounting plate.

- Finish:
- ( ) silver
  - ( ) dark bronze
  - ( ) white
  - ( ) RAL ...

GEZE TS 4000 – Ordering information

Description	Finish	ID No.
GEZE TS 4000, size 1-6 door closer without link arm	silver	102789
	dark bronze	102790
	white RAL 9016	102791
	RAL-colour	102792
GEZE TS 4000, size 5-7 door closer without link arm	silver	102837
	RAL-colour	102838
GEZE TS 4000 S, size 1-6 with delayed closing action, without link arm	silver	107745
	dark bronze	107746
	white RAL 9016	107747
	RAL-colour	107748
Link arm	silver	102421
	dark bronze	102422
	white RAL 9016	102423
	stainless steel effect <sup>1)</sup>	102426
	RAL-colour	102425
Extended link arm for transom mounting with soffit 70-170 mm	silver	102431
	dark bronze	102432
	white RAL 9016	102433
	RAL-colour	102434
Hold-open link arm can be enabled / disabled	silver	102445
	dark bronze	102446
	white RAL 9016	102447
	RAL-colour	102448
Hold-open link arm cannot be disabled	silver	102454
	dark bronze	102455
	white RAL 9016	102456
	RAL-colour	102457
Continuation GEZE TS 4000 – Ordering information, see page 18		

<sup>1)</sup> finish stainless steel effect for dry rooms only

Continuation GEZE TS 4000 – Ordering information

Description		Finish	ID No.
<b>Mounting material</b>			
Mounting plate for doors where direct mounting is not possible		silver	049185
		dark bronze	052351
		white RAL 9016	068627
		galvanised steel	057956
		RAL-colour	029176
Lintel angle bracket for transom mounting on opposite hinge side with deep soffit		silver	049240
		dark bronze	052352
Clamping plate for plate glass doors		silver	057126
		dark bronze	057127
		white RAL 9016	009491
		RAL-colour	009494
Frame plate for parallel arm mounting		silver	053318
		dark bronze	053319
Mounting plate for segmental arch doors (max. arch height 130 mm)		silver	059044
		dark bronze	059045
		RAL-colour	119472
Drilling template			053134
<b>Accessories</b>			
Cover caps (only suitable for direct installation)		silver	067724
		dark bronze	067725
		white RAL 9016	067726
		polished brass	072698
		stainless steel	072696
		RAL-colour	000756
Serrated spindle extensions <sup>1)</sup> , length:	10 mm	galvanised	103548
	15 mm	galvanised	103549
	20 mm	galvanised	103550
	10 mm	black chromated	103677
	15 mm	black chromated	103678
	20 mm	black chromated	103679

<sup>1)</sup> Only permitted for smoke and fire-proof doors if the intended use is listened in the approval notification of the door

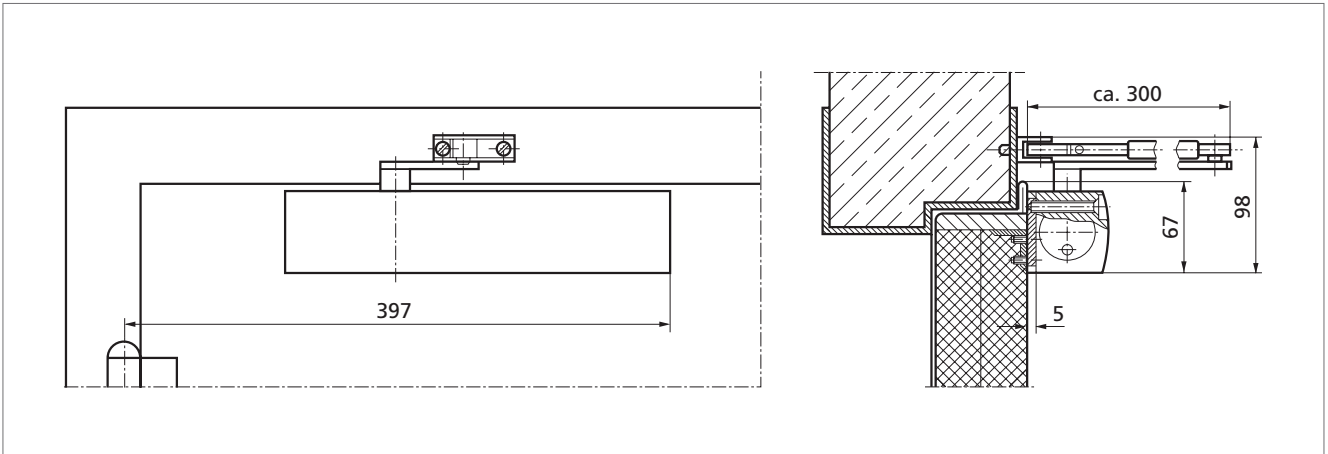

Fig. 19-1

**Mounting on hinge side / door mount**

Example showing the mounting of GEZE TS 4000 with mounting plate, see Fig. 19-1

**Installation with mounting plate**

Mounting plate, 5 mm deep, drill-hole pattern to DIN EN 1154 appendix 1, for doors where direct mounting is not possible, see Fig. 19-2

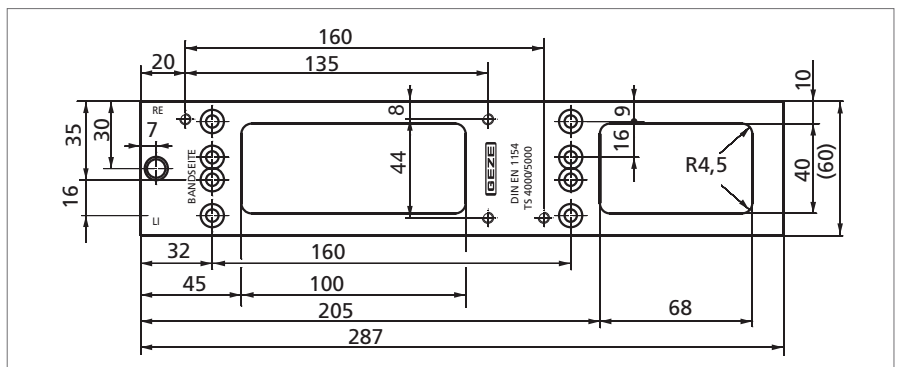

Fig. 19-2

**Mounting dimensions**

for left closing door, see Fig. 19-3  
for right closing door, see Fig. 19-4

**Direct installation**

Mounting dimensions for left closing door, see Fig. 19-5  
for right closing door, see Fig. 19-6

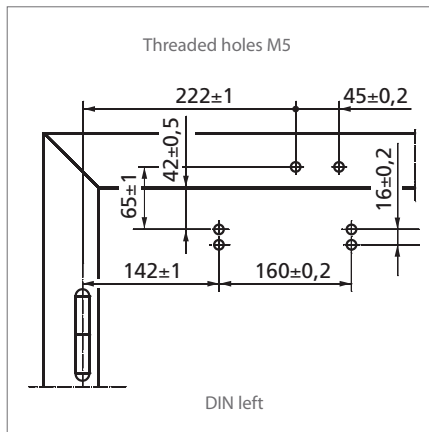

Fig. 19-3

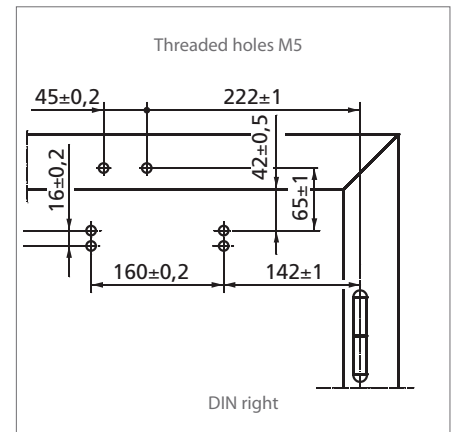

Fig. 19-4

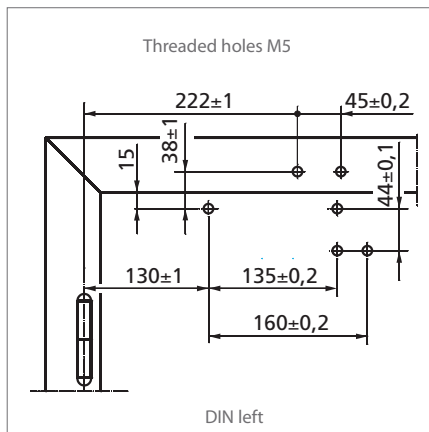

Fig. 19-5

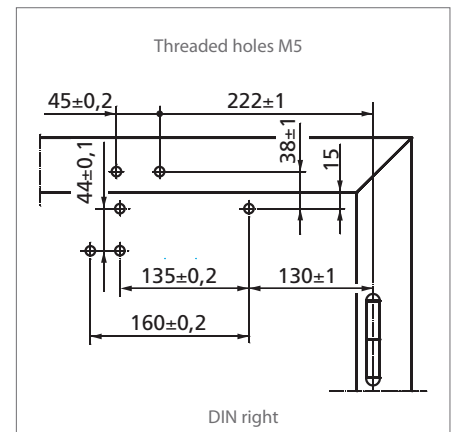

Fig. 19-6