

# 8002 Series Transom Closers

The Novas fully concealed transom closers are designed to provide positive centring and door control on manually operated single or double action internal and external Aluminium doors.

The most important factors to be considered when selecting manually operated transom closer spring strength are the door size, the environment in which the door will operate and people using the door.

## Selection of Spring Strength

For external doors, the size of the door and effect of wind upon its surface area must be considered in relation to the spring strength required to hold the door closed against wind pressure, and then this must be balanced by the ability of the users to exert sufficient pressure on the door to push it or pull it open. The push plate/pull handle must also be considered, as this may drastically diminish the available leverage.

The 8002 series is a fixed strength Transom Closer as shown on the chart below. Refer to 8000ADJ for a larger range of adjustments.



Hydraulic Unit Spring Strength			Door	
Size	Spring Strength	Closing Force (In kpm)	Maximum Width mm	Maximum Weight kg.
2	Regular	2.5	1150	80 - 120

## Regular Opening

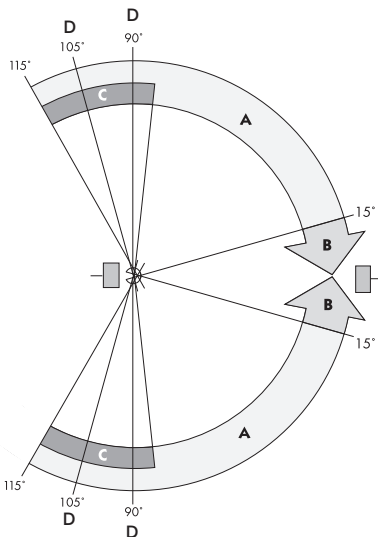

<b>A</b>	Closing Range	15° - 115°
<b>B</b>	Latching Range	0° - 15°
<b>C</b>	Backcheck Range	85° - 115°
<b>D</b>	Hold Open	90° or 115°

## Technical Data – Limiting Dimensions

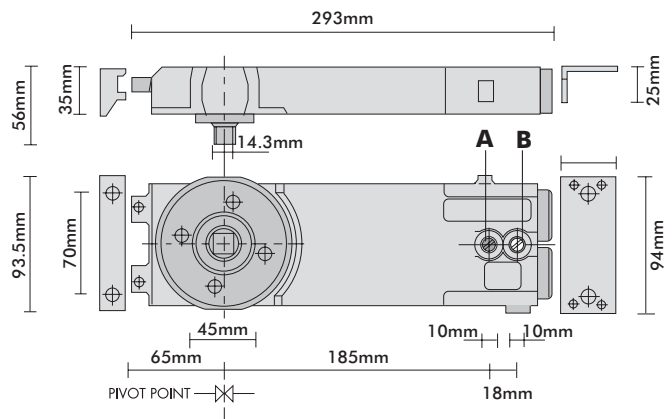

### Legend

- A.** Closing Speed
- B.** Latching Speed

### A. Closing Speed

Captive valve is conveniently located on the underneath side of the body to control the closing speed.

### B. Latching Speed

A separate adjustment valve to accelerate or decelerate the door to ensure positive centring.



# 8002 Series Transom Closers

## Technical Data

- Standard Arm 'T' option Product Code 8000-1010
- Offering lateral adjustment through hinge style
- Fully adjustable, vertically within opening & central parking positions
- Hole and centre lines in channel for easy location of pivot point
- Hexagon spanner provided  
Universal Bottom Pivot  
Product Code 800-0021
- Fully adjustable height 31.5mm to 58.5mm
- 100kg loading radial bearing
- 70mm Standard Pivot Point
- 65mm Pivot Point, Glass Door, cut on 5mm 'V' groove line
- Threshold & Tie Bar secured threaded back plate
- 1 full turn equals 2mm adjustment

## Backcheck

Built-in cushion backcheck from 85° prevents damage to doors in adverse conditions or where a door swing is limited to 90°. It is recommended that a doorstop be installed to provide a positive backdrop to prevent damage to door furniture and furnished wall surfaces. It is recommended that a door stop be installed to provide a positive backstop to prevent damage to door furniture and finished wall surfaces.

## Ordering Procedure

Cat. No.	Description
8002 NHO	Strength 2, Non Hold Open
8002 90HO	Strength 2, 90° Hold Open
8002 105HO	Strength 2, 105° Hold Open

## Side Load Arm

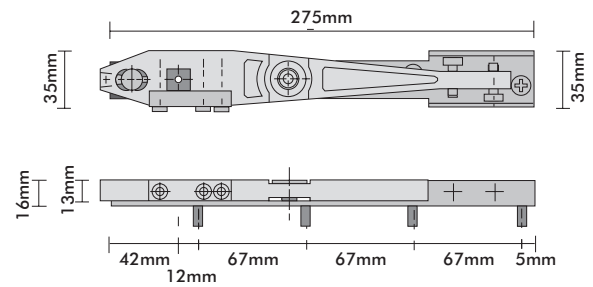

## Bottom Pivot

